

Nagambie Central



Nagambie Central is a neighbourhood shopping centre anchored by an IGA supermarket in addition to six specialty shops and an ATM. The trade area for Nagambie Central extends 20km from the centre drawing customers from across the Shire of Strathbogie region.

The Leading Choice

The centre is a single level, fully external shopping experience and represents the main convenience retail offer for the suburb of Nagambie. The centre offers its loyal customers and tourists to the region a high level of accessibility and convenience with on-grade, free, single level car parking.

Location

The rural town is located just over 130km, a two-hour drive from the Melbourne CBD. Nagambie is nestled between the pastoral and agricultural regions of Seymour and Shepperton.

Our Brands





CENTRE SNAPSHOT

	3,012m ² GLA
	\$20 million MAT sales
	7 retailers
	100+ car spaces

*Figures as at November 2025 and are correct at time of publishing

CUSTOMER SNAPSHOT

	2,036 Nagambie UCL population
	534 families
	\$1,088 median weekly household income

SOURCE: [Australian Bureau of Statistics Census 2021](#)

LEASING CONTACTS

Richard Hardie
0418 665 522
richard.hardie@mafinancial.com

Lauren Grant
0455 246 920
lauren.grant@mafinancial.com

Centre directory

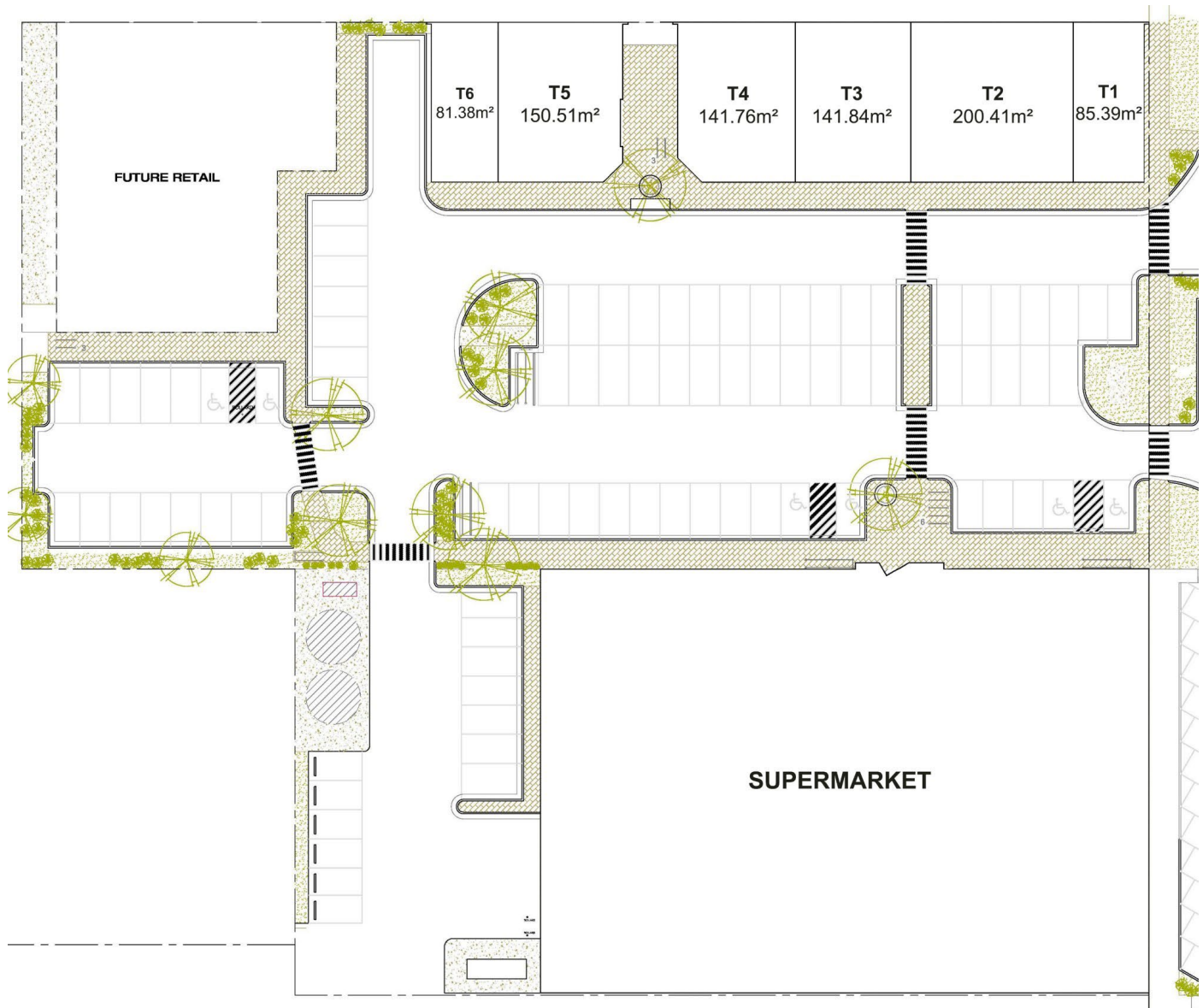

The information contained in this document is a guide only and has been prepared based on the information available to the centre owner and MA Financial Group as at the date of its publication. Neither the centre owner nor MA Financial Group (nor their agents or any person employed by them) warrant that the information in this document is accurate or complete. Further, neither the centre owner nor MA Financial Group (nor their agents or any person employed by them) have any obligation or other duty to inform you of any inaccuracy or incompleteness of the information in this document which may subsequently come to their attention. The document does not provide any predictions as to future events or outcomes and does not constitute a lease offer or warranty as to the profitability, design or layout of the centre. MA Financial Group may in its absolute discretion vary or amend this document (including without limitation by modifying, adding or removing any information (including any measurements and monetary amounts) in this document) at any time and without notice to you.

You should carry out your own investigations and satisfy yourself with regards to the matters referred to in the preceding paragraph and obtain independent legal, financial and business advice before making any decision or entering into any agreement arrangement concerning the subject matter of this document or the centre. Neither the centre owner nor MA Financial Group (nor their agents or any person employed by them) accept any responsibility for: (a) any consequence resulting either directly or indirectly from a person relying or acting upon the information contained in this document; (b) the accuracy or completeness of such information; or (c) any consequence arising from your decision to enter into a legally enforceable agreement or arrangement with the centre owner. You may not copy or use any part of this document the without express written consent of MA Financial Group. Any monetary amounts are expressed in Australian dollars unless otherwise stated. Rates are subject to change without notification.

259-261 High Street
Nagambie, VIC 3608